

Map 2

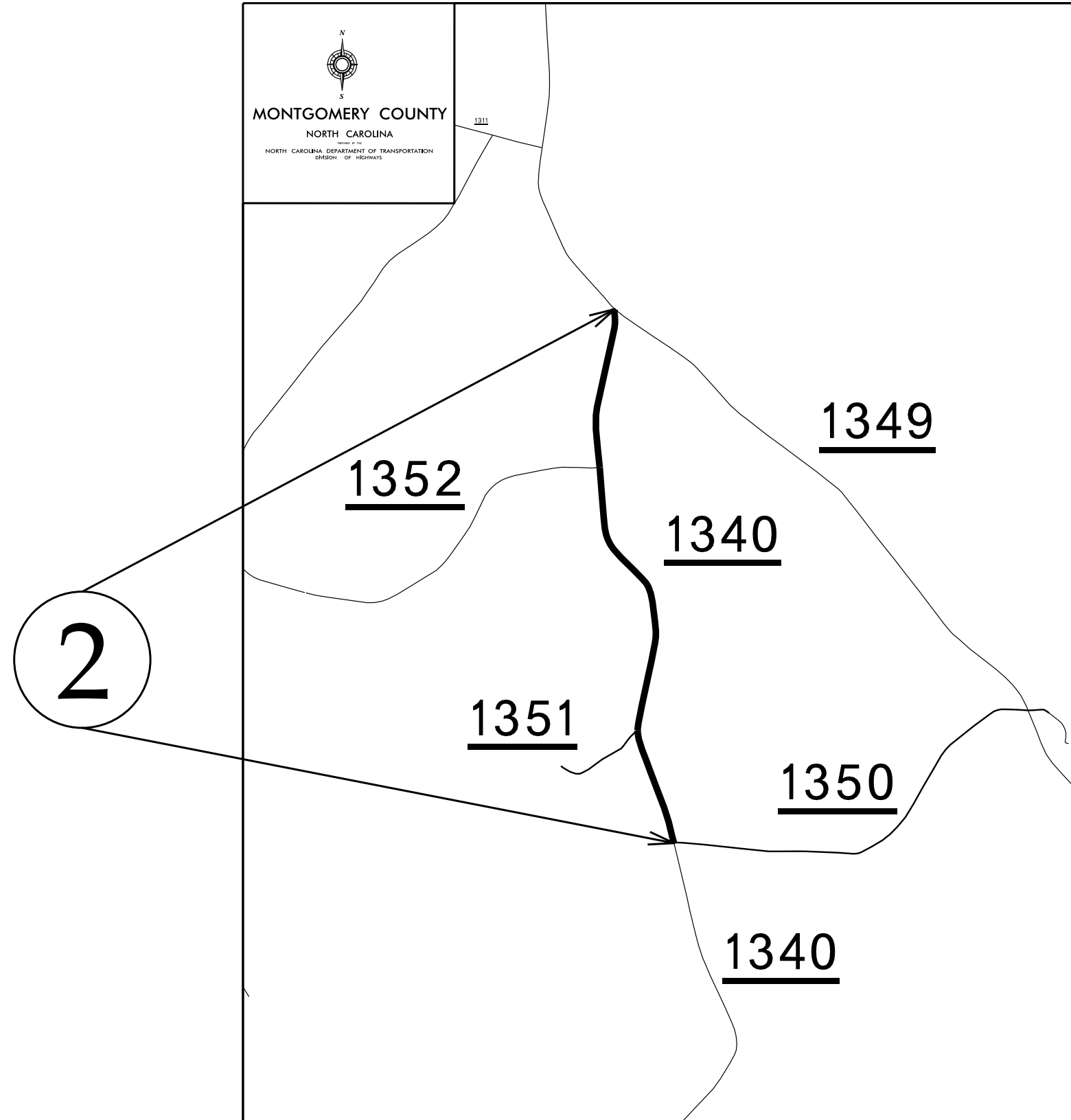

MONTGOMERY COUNTY
NORTH CAROLINA
DESIGNED BY THE
NORTH CAROLINA DEPARTMENT OF TRANSPORTATION
DIVISION OF HIGHWAYS

PROJECT NO.	SHEET NO.	TOTAL NO.
2024CPT.08.07.20622	7	

SUMMARY OF QUANTITIES

PROJECT NO	COUNTY	MAP NO	ROUTE	DESCRIPTION	TYP NO	LANES	LANE TYPE	FINAL SURFACE TESTING REQUIRED	WARM MIX ASPHALT REQUIRED	LENGTH	WIDTH	BEGIN MP	END MP	1575000000-E	1704000000-E	1803500000-E	1838000000-E	1838500000-N	2143000000-E
														ASPHALT BINDER FOR PLANT MIX	PATCHING EXISTING PAVEMENT	ASPHALT SURFACE TREATMENT, DOUBLE SEAL	EMULSION FOR ASPHALT SURFACE TREATMENT	VACUUM TRUCK	BLOTTING SAND
														MI	FT	TONS	TONS	SY	GAL
2024CPT.08.07.20622	Montgomery	1	SR-1509 / COLE RD	FROM SR 1573 (FARMERS MARKET RD) TO MOORE COUNTY	1	2	2WU	NO	NO	1.55	22	1.73	3.28	1	20	18,187.00	10,003	5.00	10
TOTAL FOR MAP NO. 1										1.55				1	20	18,187.00	10,003	5.00	10
2024CPT.08.07.20622	Montgomery	2	SR-1340 / OKEEWEMEE RD	FROM SR 1349 ETHER RD TO SR 1350 (DAN RD)	1	2	2WU	NO	NO	1.78	18	0	1.78	1	25	18,797.00	10,338		
TOTAL FOR MAP NO. 2										1.78				1	25	18,797.00	10,338		
2024CPT.08.07.20622	Montgomery	3	SR-1315 / FLOYD FARM RD	FROM PVMT JOINT +0.53 MILES FROM SR 1340 (OKEEWEMEE RD) TO NC 134	1	2	2WU	NO	NO	0.9	22	0.53	1.43	10	200	11,616.00	6,389		
TOTAL FOR MAP NO. 3										0.9				10	200	11,616.00	6,389		
2024CPT.08.07.20622	Montgomery	4	SR-1310 / LOVE JOY RD	FROM SR 1315 (SUBSTATION RD) TO SR 1314 (AUNT QUEEN RD)	1	2	2WU	NO	NO	1.32	20	4.87	6.19	1	25	16,139.00	8,876		
TOTAL FOR MAP NO. 4										1.32				1	25	16,139.00	8,876		
TOTAL FOR PROJ NO. 2024CPT.08.07.20622										5.55				13	270	64,739.00	35,606	5.00	10
GRAND TOTAL										5.55				13	270	64,739.00	35,606	5.00	10

PROJECT NO.	SHEET NO.	TOTAL NO.
2024CPT.08.07.20622	8	

THERMOPLASTIC AND PAINT QUANTITIES

PROJECT NO	COUNTY	MAP NO	ROUTE	DESCRIPTION	TYP NO	LANES	LANE TYPE	LENGTH	WIDTH	BEGIN MP	END MP	4413000000-E	4457000000-N	4810000000-E	4810000000-E
												WORK ZONE ADVANCE/GENERAL WARNING SIGNING	TEMPORARY TRAFFIC CONTROL	4" WHITE PAINT	4" YELLOW PAINT
												SF	LS	LF	LF
2024CPT.08.07.20622	Montgomery	1	SR-1509 / COLE RD	FROM SR 1573 (FARMERS MARKET RD) TO MOORE COUNTY	1	2	2WU	1.55	22	1.73	3.28	175	1.0000	32,736	32,736
TOTAL FOR MAP NO. 1								1.55				175	1	32,736	32,736
2024CPT.08.07.20622	Montgomery	2	SR-1340 / OKEEWEMEE RD	FROM SR 1349 ETHER RD TO SR 1350 (DAN RD)	1	2	2WU	1.78	18	0	1.78	200		37,594	37,594
TOTAL FOR MAP NO. 2								1.78				200		37,594	37,594
2024CPT.08.07.20622	Montgomery	3	SR-1315 / FLOYD FARM RD	FROM PVMT JOINT +0.53 MILES FROM SR 1340 (OKEEWEMEE RD) TO NC 134	1	2	2WU	0.9	22	0.53	1.43	105		19,008	19,008
TOTAL FOR MAP NO. 3								0.9				105		19,008	19,008
2024CPT.08.07.20622	Montgomery	4	SR-1310 / LOVE JOY RD	FROM SR 1315 (SUBSTATION RD) TO SR 1314 (AUNT QUEEN RD)	1	2	2WU	1.32	20	4.87	6.19	150		27,668	27,668
TOTAL FOR MAP NO. 4								1.32				150		27,668	27,668
TOTAL FOR PROJ NO. 2024CPT.08.07.20622								5.55				630	1.000	117,006	117,006
GRAND TOTAL								5.55				630	1.000	117,006	117,006

SIGNING FOR ASPHALT SURFACE TREATMENT

LEGEND

- ▷ PORTABLE SIGN
- └ STATIONARY SIGN
- ← DIRECTION OF TRAFFIC FLOW

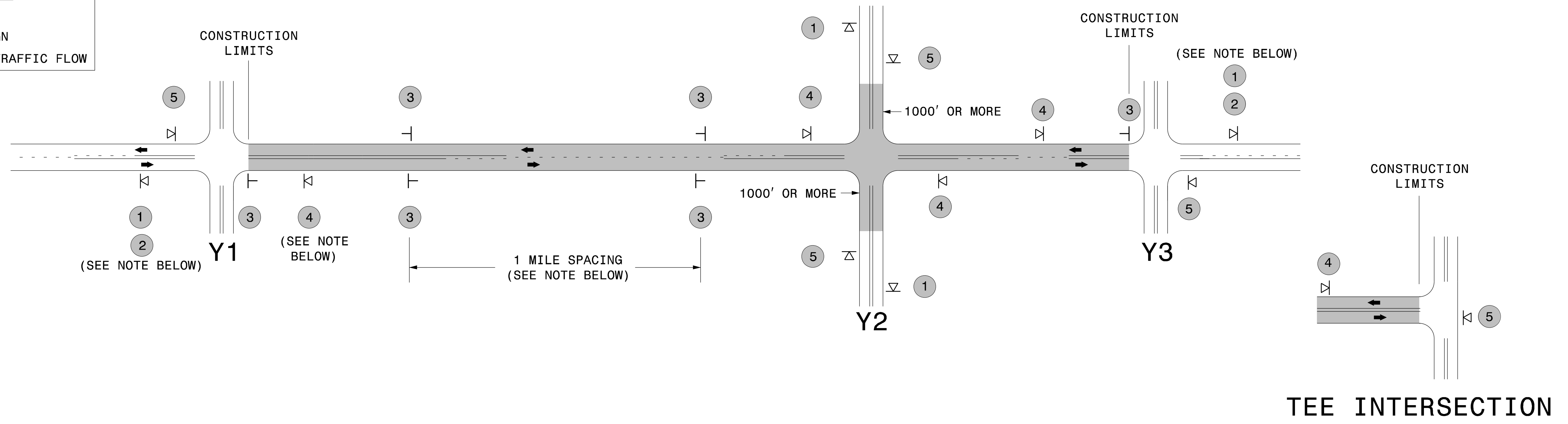

MAINLINE (-L-) SIGNING

-Y- LINE SIGNING

SIGNING NOTES AND PLACEMENT PER DIRECTION	1	 	<ul style="list-style-type: none"> - PLACE 1000' PRIOR TO BEGINNING OF CONSTRUCTION LIMITS. ONLY USED ON -Y- LINES IF RESURFACING LIMITS EXTEND 1000' ALONG -Y- LINE. - SIGN #2 ONLY USED WHEN RESURFACING LIMITS ARE 2 OR MORE MILES IN LENGTH. ROUND UP TO THE NEAREST WHOLE NUMBER. DO NOT USE FRACTIONAL OR DECIMAL NUMBERS. 	<p>STATIONARY SIGNING NOT REQUIRED FOR THE FOLLOWING -Y- LINE CONDITIONS:</p> <ol style="list-style-type: none"> 1) LESS THAN 1000' OF RESURFACING ALONG -Y- LINE 2) SUBDIVISION ROADS 3) DEAD END ROADS <p>WHEN PAVING/CONSTRUCTION ACTIVITIES PROCEED ACROSS AN UNSIGNED -Y- LINE, PORTABLE ADVANCE WARNING SIGNS SHALL BE USED ALONG THE -Y- LINE AS SHOWN BELOW. REMOVE UPON COMPLETION OF WORK.</p> <div style="display: flex; justify-content: space-around;"> <div style="text-align: center;"> <p>PLACED 500' IN ADVANCE OF FLAGGER.</p> </div> <div style="text-align: center;"> <p>PLACED 250' IN ADVANCE OF FLAGGER.</p> </div> </div>
	3	 	<ul style="list-style-type: none"> - ALTERNATE THE FOLLOWING TWO SIGNS: - STARTING WITH "LOOSE GRAVEL" (W8-7) FOLLOWED BY "UNMARKED PAVEMENT". - PLACE INITIALLY AT THE CONSTRUCTION LIMITS AND SPACED 1 MILE APART THEREAFTER. - AT TEE INTERSECTIONS INSTALL INITIALLY 0.5 MILE FROM INTERSECTION AND SPACE 1 MILE APART THEREAFTER. 	
	4		<ul style="list-style-type: none"> - THESE ARE FOR -Y- LINES THAT ARE "THROUGH" ROADWAYS. DEAD END AND SUBDIVISION ROADS ARE NOT "THROUGH" ROADWAYS. - INSTALL 500' +/- FROM EACH -Y- LINE APPROACH AS SHOWN ABOVE. - FOR MULTIPLE -Y- LINES THAT ARE SEPARATED BY 0.25 MILES OR LESS, TREAT AS A SINGLE UNIT AND INSTALL WITHIN 500' OF EACH APPROACH. - A MAXIMUM OF 2 SIGN SETS PER MILE. DO NOT INSTALL WHEN -Y- LINES ARE WITHIN 0.5 MILES FROM "END ROAD WORK" SIGN. 	
	5		<ul style="list-style-type: none"> - PLACE 500' FOLLOWING THE END OF CONSTRUCTION LIMITS OR AS SHOWN WHEN WORK ENDS AT A 3-WAY TEE INTERSECTION. 	
	<p>THE ABOVE SIGNS ARE ALL THAT ARE REQUIRED FOR A CONTRACTOR TO BEGIN A RESURFACING CONTRACT. ANY ADDITIONAL SIGNS REQUESTED BY NCDOT DIVISIONS SHALL BE INSTALLED WITHIN 7 BUSINESS DAYS OF THE START OF CONTRACT WORK.</p>			

MAPS LESS THAN 2 MILES

FOR AST RESURFACING MAPS WITH CONSTRUCTION LIMITS LESS THAN 2 MILES IN LENGTH, USE A STATIONARY "LOOSE GRAVEL" SIGN AT THE BEGINNING CONSTRUCTION LIMIT FOLLOWED BY AN "UNMARKED PAVEMENT" SIGN MIDWAY THROUGH AND AN "END ROAD WORK" SIGN AT THE END CONSTRUCTION LIMIT.

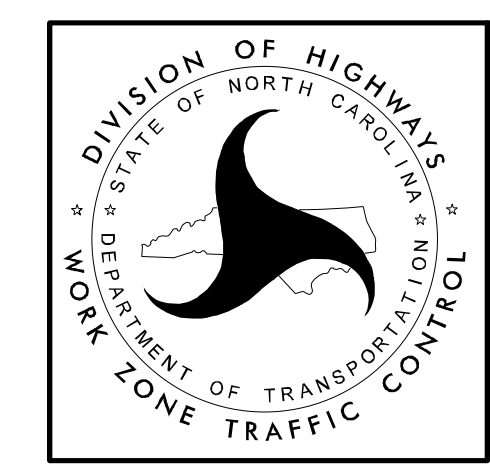

ADVANCE WARNING SIGNS FOR 2-LANE ROADWAY ASPHALT SURFACE TREATMENT